



CREATE A BETTER LIVING

Washer Dryer

OWNER'S MANUAL

MODEL :
WD1460FMW

Read This Manual 

Read all instructions and explanations for the installation before use. Follow the instructions carefully. Keep the operation instructions handy for later use. If the appliance is sold or passed on, ensure that the new owner always receives this operation instructions.



CAUTION: HOT SURFACE !



CAUTION: RISK OF FIRE !

CONTENTS

SAFETY INSTRUCTIONS

- Safety Instructions 2

INSTALLATION

- Product Description 9
- Installation 10

OPERATION

- Quick Start 13
- Before Each Washing 15
- Detergent Dispenser 16
- Control Panel 18
- Programmes.....19
- Option..... 21

MAINTENANCE

- Cleaning and Care 25
- Trouble Shooting 28
- Technical Specifications 29
- Built-in installation 30

SAFETY INSTRUCTIONS

■ Safety Instructions

Please read the following safety information thoroughly and follow it strictly to minimize the risk of fire or explosion, electric shock and to prevent property damage, personal injury or loss of life. Failing to follow these instructions shall void any warranty.

Warning!

This combination of symbol and signal word indicates a potentially dangerous situation which may result in death or serious injuries unless it's avoided.

Caution!

This combination of symbol and signal word indicates a potentially dangerous situation which may result in slight or minor injuries or damage to property and the environment.

Note!

This combination of symbol and signal word indicates a potentially dangerous situation which may result in slight or minor injuries.

Warning!

ELECTRIC SHOCK HAZARD

- If the supply cord is damaged, it must be replaced by the manufacturer, its service agent or similarly qualified persons in order to avoid a hazard.
 - If the machine is damaged, it must not be operated unless repaired by the manufacturer, its service agent or similarly qualified persons.
- Risk of electric shock!

SAFETY INSTRUCTIONS

- The appliance can be used by children aged from 8 years and above and persons with reduced physical, sensory or mental capabilities or lack of experience and knowledge if they have been given supervision or instruction concerning use of the appliance in a safe way and understand the hazards involved. Children shall not play with the appliance. Cleaning and user maintenance shall not be made by children without supervision.
- Children should be supervised that they do not play with the appliance.
- Children 3 years and under shall be kept away from the appliance or continuously supervised.
- Animals and children may climb into the machine. Check the machine before every operation.
- Do not climb or sit on the appliance.

INSTALLATION LOCATION AND SURROUNDING

- All washing and additional substances are to be kept in a safe place out of the reach of children.
- Do not install the machine on a carpet floor. The obstruction of the openings by a carpet can damage the machine.
- Keep the appliance clear from heating sources and direct sunlight to avoid plastic and rubber parts to corrode.
- Do not use the appliance in humid environments or rooms containing explosive or caustic gas. In case of water leakage or water splashes let the appliance dry in the open air.
- The appliance must not be installed behind a lockable door, a sliding door or a door with a hinge on the opposite side to that of the washer dryer.

SAFETY INSTRUCTIONS

- Do not operate the machine in rooms with a temperature of below 5°C. This can cause damages to parts of it. If it is unavoidable, make sure to drain the water completely from the appliance after every use (see „Maintenance - Cleaning of drain pump filter“) to avoid damages caused by frost.
- Never use flammable sprays or substances in the immediate proximity of the appliance.

INSTALLATION

- Remove all packaging material and transport bolts before using the appliance. Otherwise, serious damage may result.
- This appliance is equipped with a single inlet valve and can be connected to the cold water supply only.
- Mains plug must be accessible after installation.
- Before washing clothes for the first time, the product shall be operated once throughout all the procedures without any clothes inside.
- Before using the washer dryer, the product shall be calibrated.
- Do not put any excessively heavy objects on the appliance, like water containers or heating devices.
- The new hose-sets supplied with the appliance are to be used and that old hose-sets should not be reused.
- Max. Inlet water pressure 1 MPa. Min. inlet water pressure 0.05 MPa.

ELECTRICAL CONNECTION

- Make sure the supply cable is not trapped by the machine, it can get damaged.
- Connect the product to a grounded outlet protected by a fuse complying with the values in the “ Technical specifications ” table. The grounding installation has to be made by a qualified electrician. Ensure that the machine is installed in accordance with the local regulations.

SAFETY INSTRUCTIONS

•Water and electrical connections must be carried out by a qualified technician in accordance with the manufacturer's instructions and local safety regulations.

Warning!

- Don't use multiple plugs or extension cords.
- The appliance must not have an external switching device such as a timer or connected to a circuit that is regularly switched on and off.
- Do not pull the plug out of the mains outlet if there is flammable gas around.
- Never pull out power plug with wet hands.
- Always pull at the plug, not at the cable.
- Always unplug the appliance if it is not being used.

WATER CONNECTIONS

- Check the connections of the water inlet tubes, the water tap and the outlet hose for possible problems due to changes of water pressure. If the connections loosen or leak close the water tap and get it repaired. Do not use the appliance before the pipes and hoses are installed properly by qualified persons.
- Glass door may become very hot during the operation. Keep children and pets far away from the machine while it is operating.
- The water inlet and outlet hoses have to be safely installed and remain undamaged. Otherwise, water leakage can occur.
- Do not remove the drain pump filter while there is still water in the appliance. Big quantities of water can leak out, and there is a risk of scalding due to hot water.

SAFETY INSTRUCTIONS

OPERATION AND MAINTENANCE

Warning!

- Never stop the washer dryer before the end of the drying cycle unless all items are quickly removed and spread out so that the heat can dissipate.
- The washer dryer is not to be used if industrial chemicals have been used for cleaning. Risk of explosion.

- Never use any flammable, explosive or toxic solvents. Do not use gasoline and alcohol etc. as detergents. Only select detergents that are suitable for machine washing.
- Make sure that all pockets are emptied. Sharp and rigid items such as coins, brooches, nails, screws, stones etc. may cause serious damages to this machine.
- Remove all objects from pockets such as lighters and matches before use the appliance.
- Thoroughly rinse items that have been washed by hand.
- Do not dry unwashed items in the appliance.
- Items that have been soiled with substances such as cooking oil, acetone, alcohol, petrol, kerosene, spot removers, turpentine, wax and wax removers should be washed in hot with an extra amount of detergent before being dried in the appliance.
- Items containing foam rubber (latex foam), shower caps, water proof textiles, rubber backed articles and clothes or pillows fitted with foam rubber pads should not be dried in the machine
- Fabric softeners or similar products should be used as recommended in their instructions.
- Never try to open the door forcefully. The door will unlock shortly after the end of a cycle.
- Please do not close the door with excessive force. If it is found difficult to close the door, please check if the clothes are properly inserted and distributed.

SAFETY INSTRUCTIONS

- Always unplug the appliance and close the water tap before cleaning and maintenance and after each use.
- Never pour water over the appliance for cleaning purpose. Risk of electric shock!
- Repairs shall only be carried out by the manufacturer, its service agent or similarly qualified persons in order to avoid a hazard. The producer will not be responsible for damages caused by the intervention of not authorized persons.

TRANSPORT

- Before Transport:
 - Bolts shall be reinstalled to the machine by a specialized person
 - Accumulated water shall be drained out of the machine
- This appliance is heavy. Transport with care. Never hold any protruding part of the machine when lifting. The machine door cannot be used as a handle.

INTENDED USE

The product is intended only for home use and for textiles in household amounts suitable for machine washing and drying. This appliance is for indoor use only and not intended for built in use. Only use according to these instructions. The appliance is not intended for commercial use.

Any other use is considered as improper use. The producer is not responsible for any damage or injuries that may result of it.

- This appliance is intended to be used in household and similar applications such as:
 - Staff kitchen areas in shops, offices and other working environments;
 - Farm houses;
 - By clients in hotels, motels and other residential type environments;
 - Bed and breakfast type environments;
 - Areas for communal use in blocks of flats or in launderettes.

SAFETY INSTRUCTIONS

Packaging/Old appliance



This marking indicates that this product should not be disposed with other household wastes throughout the EU. To prevent possible harm to the environment or human health from uncontrolled waste disposal, recycle it responsibly to promote the sustainable reuse of material resources. To return your used device, please use the collection systems or contact the retailer where the product was purchased. They return and can take this product for environmental safe recycling.

INSTALLATION

■ Product Description

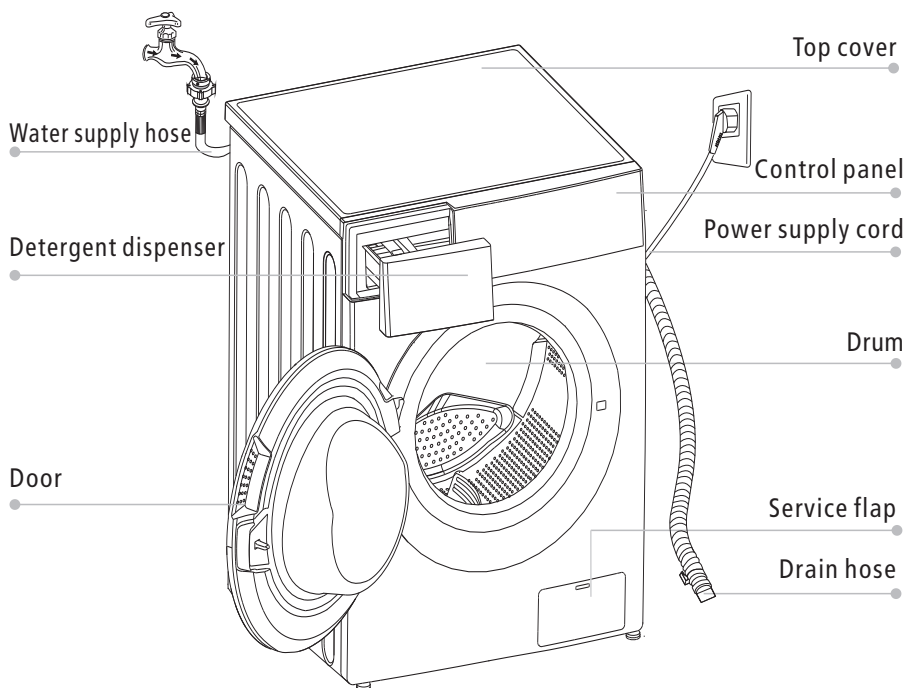

Note!

- The product picture is for illustration only, please refer to real product as reference.

Accessories

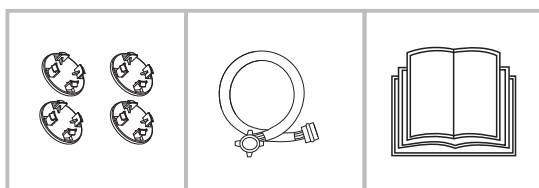

4 x Cover caps

1 x Supply hose
cold water

1 x Owner's manual

INSTALLATION

■ Installation

Installation area

⚠ Warning!

- Stability is important to prevent the product from wandering! Make sure the machine is standing leveled and stable.
- Make sure that the product does not stand onto the power cord.
- Make sure to maintain the minimum distances from the walls as shown in the picture

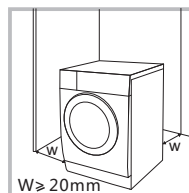

Before installing the machine, the location characterized as follows shall be selected:

1. Rigid, dry, and level surface
2. Avoid direct sunlight
3. Sufficient ventilation
4. Room temperature is above 0°C
5. Keep far away from the heat sources such as coal or gas burning appliances.

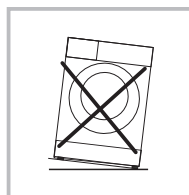

Unpacking the washer dryer

⚠ Warning!

- Packaging material (e.g. Films, Styrofoam) can be dangerous for children.
- There is a risk of suffocation ! Keep all packaging well away from children.

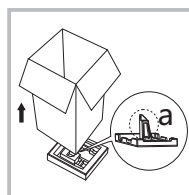

1. Remove the cardboard box and styrofoam packing.
2. Lift the washer dryer and remove the base packaging. Make sure the small triangle foam (a) is removed with the bottom packaging together. If not, lay the unit down on the side surface and remove it manually.
3. Remove the tape securing the power supply cord and drain hose.
4. Remove the inlet hose from the drum.

INSTALLATION

Remove transport bolts

⚠ Warning!

- You must remove the transport bolts from the backside before using the product.



Loosen the 4 transport bolts with a spanner.

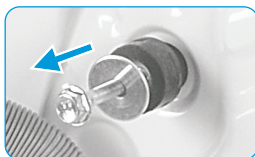

Remove the bolts including the rubber parts and keep them for future use.

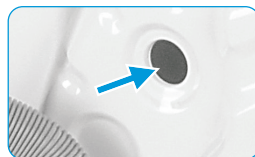

Close the holes using the cover caps.

Levelling the washer dryer

⚠ Warning!

- The lock nuts on all four feet must be screwed tightly against the housing.

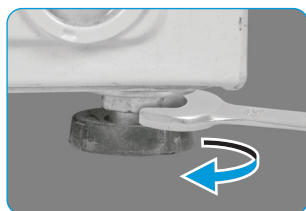

1. Loosen the lock nut.
2. Turn the foot until it reaches the floor.
3. Adjust the legs and lock the nuts with a spanner. Make sure the machine is level and steady.

Connect the water supply hose

⚠ Warning!

To prevent leakage or water damage, follow the instructions in this chapter

- Do not kink, crush or modify water inlet hose.



Connect the water supply hose to the water inlet valve and a water tap with cold water as indicated.



🔧 Note!

- Connect manually, do not use tools. Check if the connections are tight.

INSTALLATION

Drain Hose

⚠ Warning!

- Do not kink or protract the drain hose.
- Position drain hose properly ,otherwise damage might result of water leakage.

There are two ways to place the end of drain hose:

1.Put it into the water trough.

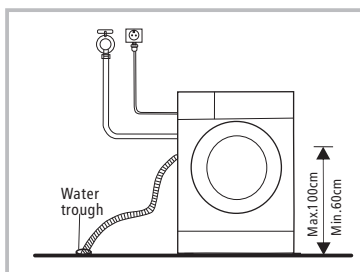

2.Connect it to the branch drain pipe of the trough.

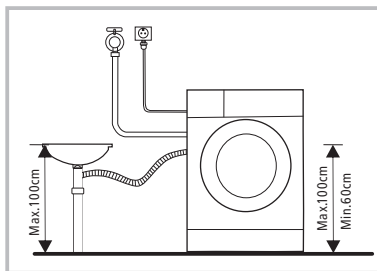

OPERATION

■ Quick Start

⚠ Caution!

- Before washing, please make sure the washer dryer is installed properly.
- Your appliance was thoroughly checked before it left the factory. To remove any residual water and to neutralize potential odors, it's recommended to clean your appliance before first use. For this reason, start the Cotton program at 90°C without laundry and detergent.

📌 Calibration

It's recommended to calibrate the washer dryer, so that provide the best performance.

The appliance is able to detect the amount of laundry loaded. This function is optimizing the product performance by minimizing energy and water consumption, saving you money and time. For this reason it's recommended to calibrate the appliance for best use.

- 1- Remove all accessories from the drum and close the door;
- 2- Insert the mains plug to the socket;
- 3- Switch on the washer dryer and press "Speed" and "Delay" simultaneously for 10 seconds until "t19" is displayed;
- 4- Press [▷||] to start the appliance and wait till "*****" is displayed.

OPERATION

1. Before Washing

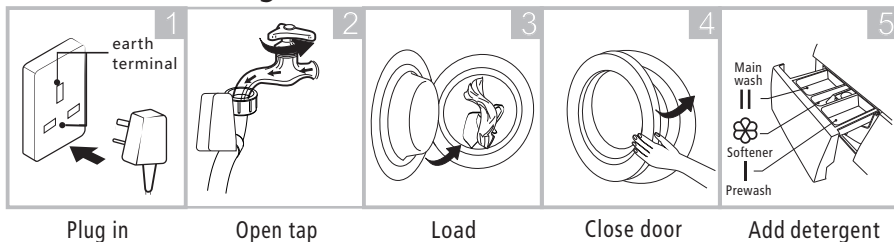

Note!

- Detergent need to be added in compartment I if the pre-wash function is selected.

2. Washing

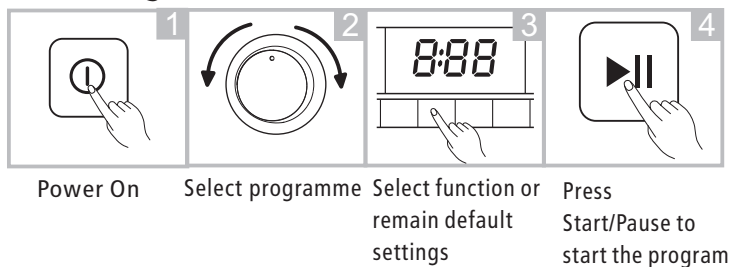

3. After Washing

Buzzer beep and "End" on display.

OPERATION

■ Before Each Washing

- The ambient temperature of the washer dryer should be 5-40°C. If used under 0°C, the inlet valve and draining system may be damaged. If the machine is installed under freezing conditions, it should be transferred to normal ambient temperature to ensure the water supply hose and drain hose can unfreeze before use.
- Please check your laundry care labels and the detergent use instructions before wash. Use non-foaming or less-foaming detergent suitable for machine washing properly.

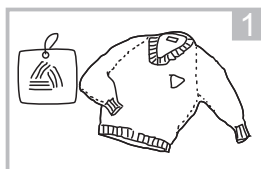

Check the care label

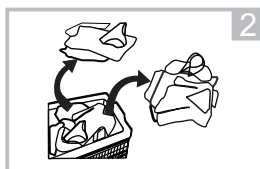

Sort laundry according to color and textile type

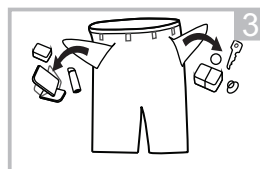

Take all items out of the pockets

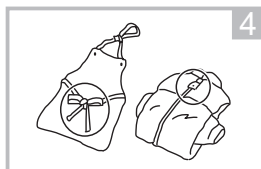

Tie together long textile strips and belts, close zips and button

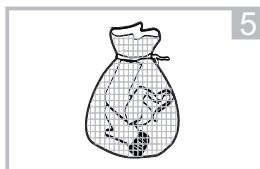

Put small items into a laundry bag

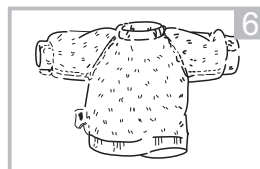

Turn easy-pilling and long-pile fabric inside out

⚠ Warning!

- Do not wash or dry articles that have been cleaned in, washed in, soaked in, or dabbed with combustible or explosive substances like wax, oil, paint, gasoline, alcohol, kerosene, and other flammable materials.
- Washing single clothes items may easily create big eccentricity and cause alarm due to unbalance. Therefore it is suggested to add one or two more laundry items to the wash so that spin can be done smoothly.

OPERATION

■ Detergent Dispenser

- I Pre wash
- II Main wash
- ☼ Softener
- ☼ Release button to pull out the dispenser

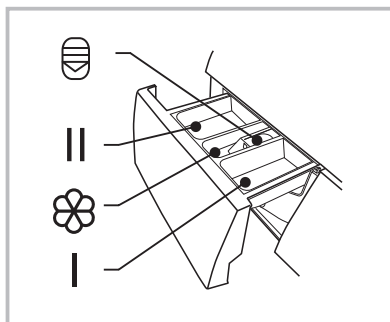

⚠ Caution!

- Detergent only need to be added in "compartment I "after selecting pre-wash function.

Programme	I	II	☼	Programme	I	II	☼
Cotton		●	○	Dry Only			
1 Hour W/D		●	○	Spin Only			
Jeans		●	○	Quick		●	○
Mix		●	○	Sport Wear		●	○
Wool		●	○	Baby Care		●	○
Rinse&Spin			○	Wash and Dry		●	○
Cotton 60°C		●	○	Intensive		●	○
20°C		●	○				

OPERATION

Detergent Recommendation

Recommended washing detergent	Wash cycles	Washing temp.	Type of laundry and textile
Heavy-duty detergent with bleaching agents and optical brighteners	Cotton, Cotton 60°C, Intensive	40/60	White laundry made from boil-proof cotton or linen
Colour detergent without bleaching agent and optical brighteners	Intensive, Cotton, Cotton 60°C, Mix, 20°C	20/30/40	Coloured laundry made from cotton or linen
Color or mild detergent without optical brighteners	20°C	Cold/20	Coloured laundry made from easy care fibres or synthetic materials
Mild washing detergent	20°C	Cold/20	Delicate textiles, silk, viscose
Special wool detergent	Wool	20/30/40	Wool

Note!

- Agglomerating or ropy detergent or additive can be diluted in some water before pouring it into the detergent dispenser, to avoid its inlet to get blocked and thus cause a water overflow.
- Please choose the suitable type of detergent to get a maximum of washing performance and a minimum of water and energy consumption
- To achieve the best cleaning result a proper detergent dosing is important.
- Use a reduced detergent amount if the drum is not filled completely.
- Always adjust the amount of detergent to the water hardness, if your tap water is soft, use less detergent.
- Dose according to how dirty your laundry is, less dirty clothes require less detergent.
- Highly concentrated (compact detergent) requires particularly accurate dosing.

Following symptoms are a sign of detergent overdosing:

- heavy foam formation
- poor washing and rinsing result

Following symptoms are a sign of detergent underdosing:

- laundry turns grey
- built-up of limescale deposits on the drum, the heating element and/or the laundry

OPERATION

■ Control Panel

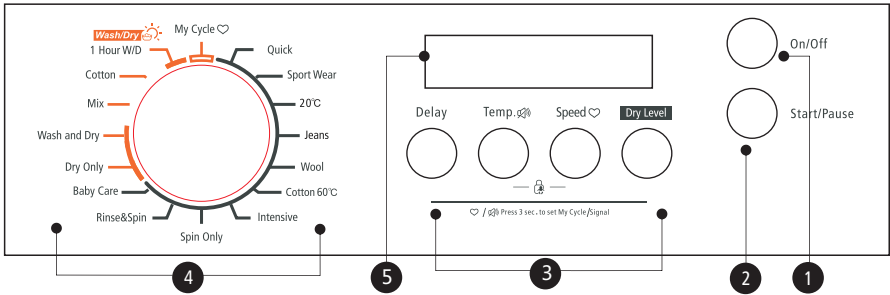

1 On/Off

Turn the appliance on and off.

2 Start/Pause

Start or pause your programme.

3 Option

This allows you to select additional functions and will light when selected.

4 Programmes

Available according to the laundry type.

5 Display

The display shows settings, estimated remaining time, options and status messages.

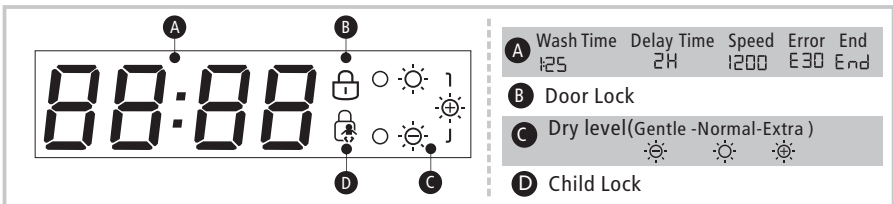

OPERATION

■ Programmes

Programme	Washing/Drying Load (kg)	Temp.(°C)	Default Time(H)
	8.0	Default	8.0
			1400
Quick	2.0	Cold	0:15
Sport Wear	4.0	40	1:11
20°C	4.0	20	1:01
Jeans	8.0	60	1:45
Wool	2.0	40	1:07
Cotton 60°C	8.0	—	3:35
Intensive	8.0	40	3:48
Spin Only	8.0	—	0:12
Rinse&Spin	8.0	—	0:20
Baby Care	8.0	60	1:43
☀ Dry Only	6.0	—	4:14
☀ Wash and Dry	6.0	—	5:00
☀ Mix	8.0/6.0	40	1:20
☀ Cotton	8.0/6.0	40	3:49
☀ 1 Hour W/D	1.0/1.0	Cold	0:58

Note!

- The parameters in this table are only for user's reference. The actual parameters maybe different with the parameters in above mentioned table.
- The programme with ☀ can be chosen dry function.

Caution!

- If there is any break in the power supply while the machine is operating, a special memory stores the selected programme. The machine will continue the programme when the power supply is re-established.

OPERATION

■ Programmes

Programmes are available according to the laundry type.

Programmes	
Cotton	Hard-wearing textiles, heat-resistant textiles made of cotton or linen.
Baby Care	Washing the baby's clothes, it can make the baby's wear cleaner and make the rinse performance better to protect the baby skin.
Jeans	Specially for jeans.
Mix	Mixed load consisting of textiles made of cotton and synthetics.
Sport Wear	Washing the activewear.
Quick	Extra short programme approx, suitable for lightly soiled washing as a small amounts of laundry.
Wool	Hand or machine-washable wool or richwool textiles. Especially gentle wash programme to prevent shrinkage, longer programme pauses (textiles rest in wash liquor).
Spin Only	Extra spin with selectable spin speed.
Rinse&Spin	Extra rinse with spin.
Dry Only	Select it to dry clothes, the temperature is different. The drying time according to the load.
1 Hour W/D	For small synthetic clothes or shirts, load limitation is 1 kg (about 4 shirts). When you have an urgent appointment but no more clean shirt left in your cupboard, this program will help you. Time duration is only 1 hour including wash and dry. Remark: Big towels or jeans is not suitable for this program, they will enlarge the time duration and affect the moisture content.
Cotton 60°C	Washing brightly colored clothes, it can protect the colors better. Default 40°C, not selectable, suitable for laundry washing at about 40°C-60°C.
Intensive	To increase the washing effects, washing time is increased.
20°C	20°C default, can choose cold water.
Wash and Dry	The standard energy program.

OPERATION

■ Option

Cycle	Default Temp.(°C)	Default spin speed in rpm	Additional functions
1400			
Quick	Cold	800	Delay
Sport Wear	40	800	Delay
20°C	20	1000	Delay
Jeans	60	1000	Delay
Wool	40	600	Delay
Cotton 60°C	--	1400	Delay
Intensive	40	800	Delay
Spin only	--	1000	Delay
Rinse&Spin	--	1000	Delay
Baby care	60	800	Delay
Dry Only	--	1400	Delay, ☀
Wash and Dry	--	1400	Delay, ☀
Mix	40	800	Delay, ☀
Cotton	40	1400	Delay, ☀
1 Hour W/D	Cold	1400	Delay, ☀

Note!

- For the maximum spin speed, program time, and other details of the Cotton 60°C and Wash and Dry programs, please refer to the content on the Product Fiche page.
- The table shows which cycle offers which options for adjustment. If an adjustment is not possible for a cycle.

OPERATION

Delay

Delay

Set the Delay function:

1. Select a programme
2. Press the Delay button to choose the time (the delaying time is 0-24 H.)
3. Press [Start/Pause] to commence the delay operation



On/Off

Choose the Programme

Setting time

Start

Cancel the Delay function:

Press the [Delay] button until the display be 0H. It should be pressed before starting the programme. If the programme already started, should press the [On/Off] button to reset the programme.



My Cycle

Memory the frequently used programmes

Press [♥] 3sec. to memory the running programme. The default is cotton.



Child Lock

To avoid mis operation by children.



On/Off

Start/Pause

Press [Temp.] and [Speed]
3 sec. till buzzer beep.

! Caution!

- Press the two button 3sec. also to be released the function.
- The "Child Lock" will lock all buttons except [On/Off].
- Cut off the power supply, the kid's protection is to be released.
- The child lock will remain effective when the power is resumed for some models.

OPERATION

Speed

Spin Speed

When needed, the spinning speed can be adjusted pressing the Speed button in the following steps: 1400: 0-400-600-800-1000-1200-1400

⚠ Caution!

- When the lights of speed are off means the spin speed is 0.

Temp.

Temp.

Press the button to regulate the temperature(Cold,20°C,30°C, 40°C,60°C,90°C)



Mute the buzzer



On/Off

Start/Pause

Press the [Temp.]button for 3sec.the buzzer is mute.

To act the buzzer function, press the button again for 3 seconds. The setting will be kept until the next reset.

⚠ Caution!

- After Muting the buzzer function, the sounds will not be activated any more.

OPERATION



Dry Level

Press the Dry Level button continuously to choose the dry level: Extra Dry/Normal Dry/ Gentle Dry.

[d-3] ☀ Extra Dry: Need to wear clothes immediately, we can choose this function

[d-2] ☀ Normal Dry: The normal dry procedure

[d-1] ☀ Gentle Dry: Only to dry slightly and then is just ok.



Note!

- Drying hints
 - Clothes could be dried after spinning
 - To ensure quality dry the textiles, please classify them according to their kinds and the drying temperature.
 - Synthetic should be set the proper drying time.
 - If you want to iron the clothes after drying, please put them for a while.
- Clothes not suitable for drying
 - Particularly delicate items such as synthetic curtains, woolen and silk, clothes with metal inserts, nylon stockings, bulky clothes, such as anoraks, bedcovers, quilts, sleeping bags and duvets must not be dried.
 - Clothes padded with foam-rubber or materials similar to foam-rubber must not be machine dried.
 - Fabrics containing residues of setting lotions or hair sprays, nail solvents or similar solutions must not be machine dried in order to avoid the formation of harmful vapours.

MAINTENANCE

■ Cleaning and Care

⚠ Warning!

- Always unplug the appliance and close the water tap before cleaning and maintenance.

Cleaning the Cabinet

Proper maintenance on the washing machine can extend its working life. The surface can be cleaned with diluted non-abrasive neutral detergents when necessary. If there is any water overflow, use a cloth to wipe it off immediately. Never use sharp items to clean the appliance.

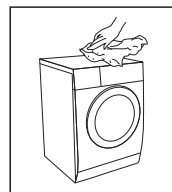

⚠ Caution!

- Never use abrasive or caustic agents, formic acids or its diluted solvents or similar substances, like alcohol or chemical products.

Cleaning the Drum

Any rust stains left inside the drum by metal articles must be removed immediately using chlorine-free detergents. Never use steel wool for cleaning the drum!

📌 Note!

- Keep any laundry away from the machine while cleaning the drum.

Cleaning the Door Seal and Glass

Wipe the glass and seal after each wash to remove lint and stains. If lint builds up it can cause leakages. Remove any coins, buttons and other objects from the seal after each wash. Clean the Door Seal and Glass every month to ensure the normal operation of the appliance.

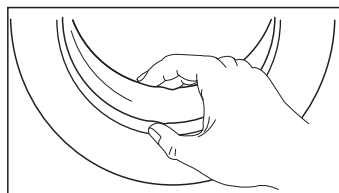

MAINTENANCE

Cleaning the Inlet Filter

Note!

- Diminishing water flow is a sign that the filter need to be cleaned.

1. Close the tap and remove the water supply hose from it.
2. Clean the filter with a brush.
3. Unscrew the water supply hose from the backside of the machine. Pull out the filter with long nose pliers.
4. Use a brush to clean the filter.
5. Reinstall the filter to the water inlet and reconnect the water supply hose.
6. Clean the Inlet filter every 3 months to ensure the normal operation of the appliance.

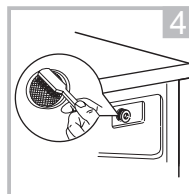
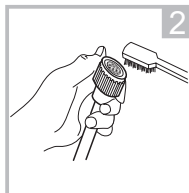
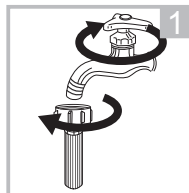

Clean The Detergent Dispenser

1. Press down the release [] on the softener cover and pull the dispenser drawer out of the recess. Clean the inside of the recess with a brush.
2. Lift the softener cover off the dispenser drawer and wash both items with water.
3. Restore the softener cover and push the drawer back into the recess.

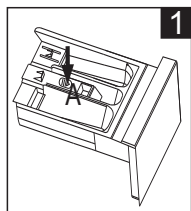

Pull out the dispenser drawer with press the A

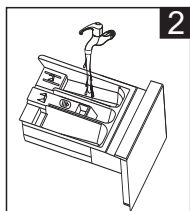

Clean the dispenser drawer under water

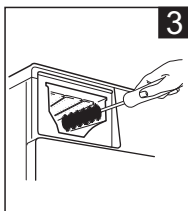

Clean inside the recess with an old toothbrush

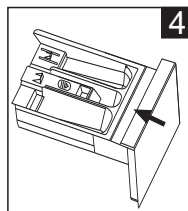

Insert the dispenser drawer

Note!

- Do not use abrasive or caustic agents to clean plastic parts.
- Clean the detergent dispenser every 3 months to ensure the normal operation of the appliance

MAINTENANCE

Cleaning the Drain Pump Filter

⚠ Warning!

- Be careful of the hot water!
- Allow detergent solution to cool down.
- Unplug the machine to avoid electrical shock before washing.
- Drain pump filter can filter the yarns and small foreign matters from the washing.
- Clean the filter periodically to ensure the normal operation of washing machine.
- Clean the filter periodically every 3 months to ensure the normal operation of the appliance.

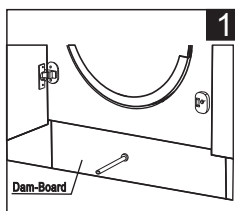

After the power is disconnected, pull out the Dam-Board.

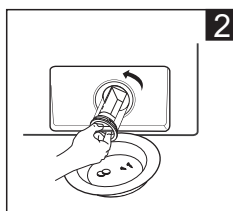

Turn the filter down as shown with the figure and take out sundries matters.

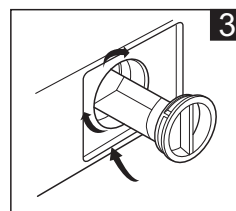

Reinstall each part back after sundries matters are removed.

⚠ Caution!

- Make sure emergency drain hose cap and the emergency drain hose are reinstalled properly, otherwise water may leak.

MAINTENANCE

■ Trouble Shooting

Whenever there is a problem with the appliance, check if you can solve it following the tables below. If the problem persists, please contact the customer service.

Description	Possible cause	Solution
Appliance does not start	Door is not closed properly. Clothes are stuck.	Close the door properly and restart. Check the laundry.
Door can't be opened	Safety protection is activated.	Disconnect the power and restart.
Water leakage	Connections are not tight enough.	Check and fasten the water inlet pipe. Check and clean the outlet hose.
Detergent residues in the detergent dispenser	Detergent is damp and/or clotted.	Clean and wipe the detergent dispenser dry.
Indicator or display does not work	PC board or harness have connection problems.	Switch off the power and check if the mains plug is connected properly.
Abnormal noise	Fixing bolts still in place. Floor is not solid or level.	Check if the fixing bolts have been removed Make sure the appliance is installed on a solid and level floor.

Error Codes

Description	Possible cause	Solution
E30	Door is not closed properly	Close the door properly and restart.
E10	Water injecting problem during wash cycle.	Check if the water pressure is high enough. Straighten the water pipe. Clean the inlet valve filter.
E21	Overtime water draining	Check the drain hose for blockage.
E12	Water overflow	Restart the appliance.
EXX	Others	Restart the appliance. If problem persists, please contact the customer service.

MAINTENANCE

■ Customer service

In case of questions please contact our customer service at:

Warning!

Risk of electric shock

- Never try repair an appliance which is defective or presumed to be defective.
You may put your own and future users' lives in danger. Only authorised specialists are allowed to carry out this repair work.
- Improper repair will void the warranty and subsequent damages can't be recognised!

Transport

IMPORTANT STEPS WHEN MOVING THE APPLIANCE

- Unplug the appliance and close the water inlet tap.
- Check, if the door and the detergent dispenser are closed properly.
- Remove the water inlet pipe and the outlet hose from the house installations.
- Let the water drain completely from the appliance (see "Maintenance Cleaning the drain pump filter")
- Important: Re-install the 4 transport bolts in the back of the appliance.
- This appliance is heavy. Transport with care. Never hold any protruding part of the machine when lifting. The machine door cannot be used as a handle.

■ Technical Specifications

Power Supply	220-240V~,50Hz
--------------	----------------

MAX.Current	10A
-------------	-----

Standard Water Pressure	0.05MPa~1MPa
-------------------------	--------------

Model	WD1460FMW
-------	-----------

Power Supply	220-240V~,50Hz
--------------	----------------

Washing Capacity	8.0kg
------------------	-------

Drying Capacity	6.0kg
-----------------	-------

Dimension(W*D*H)	595*540*825
------------------	-------------

Weight	64kg
--------	------

Rated Power	1900W
-------------	-------

Drying Power	1300W
--------------	-------

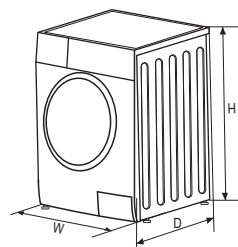

MAINTENANCE

■ Built-in installation

Appendix

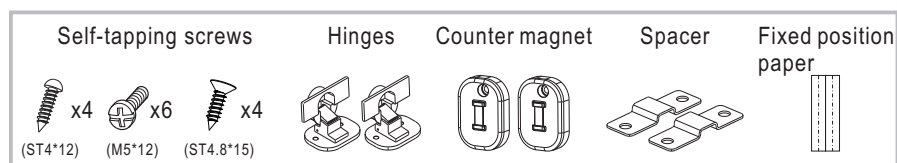

Tool

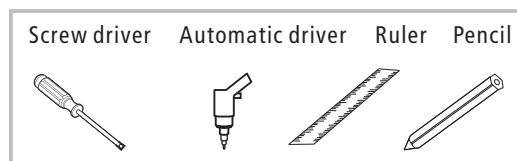

Install Steps

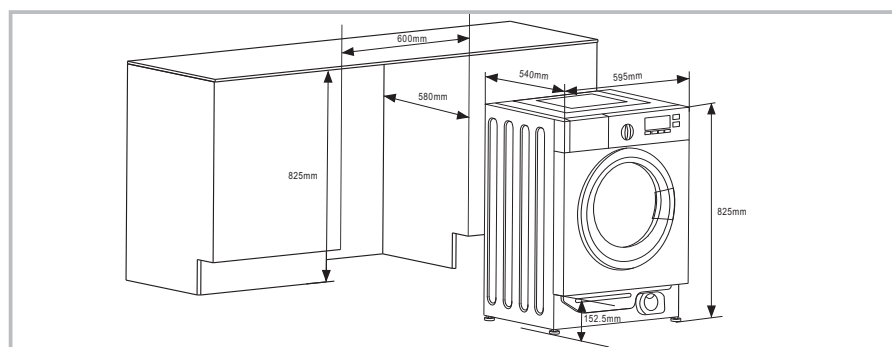

Overview

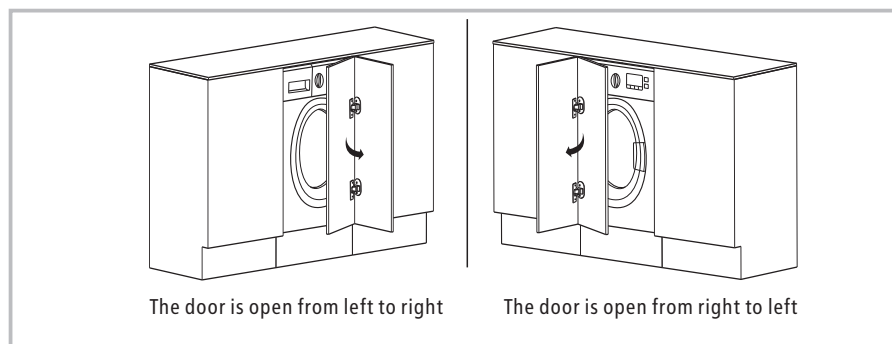

Preparation and assembly of the door

MAINTENANCE

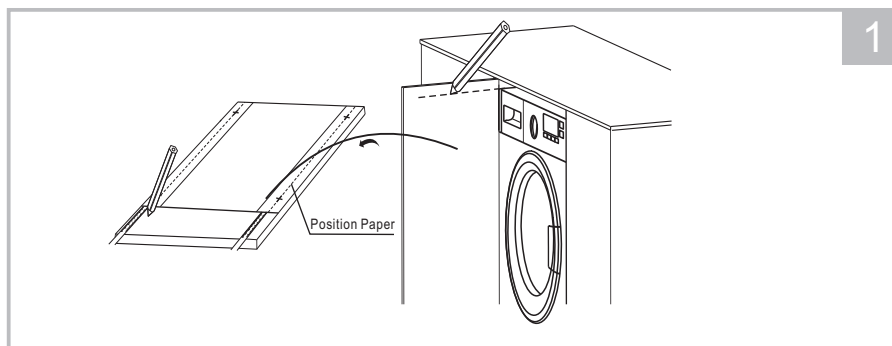

Make the mark on the door

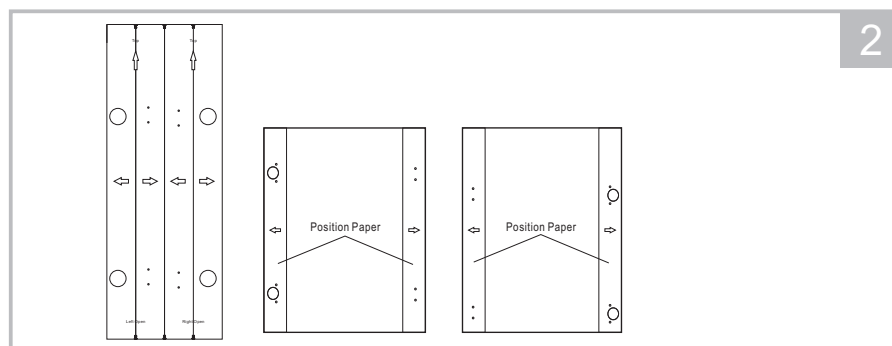

Fixed position paper on the door.

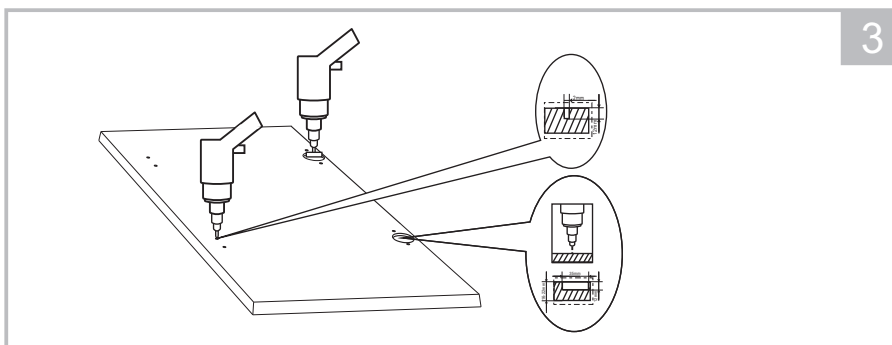

Drill hole on the door

MAINTENANCE

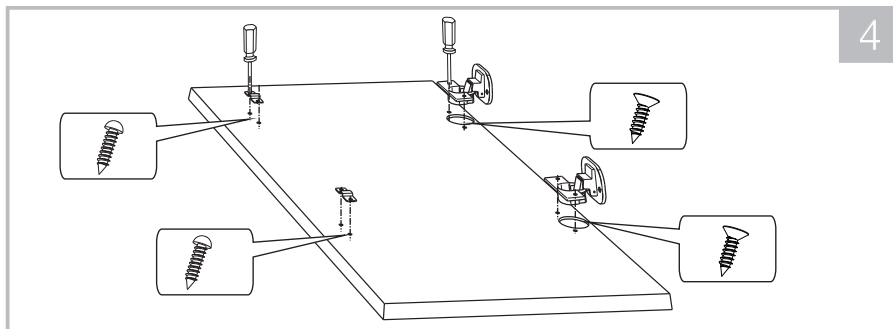

Installation the hinges and spacer

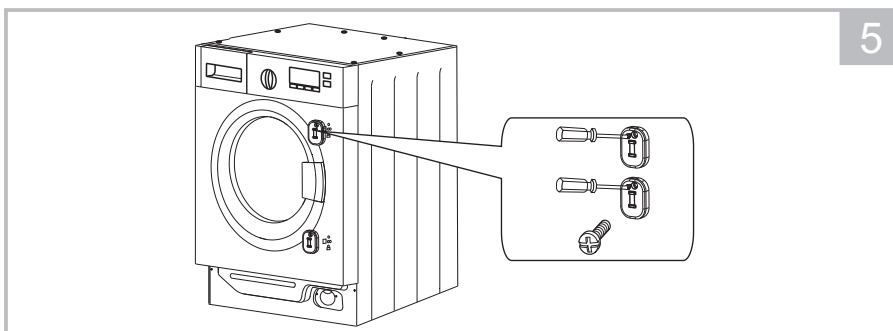

Installation the counter magnet

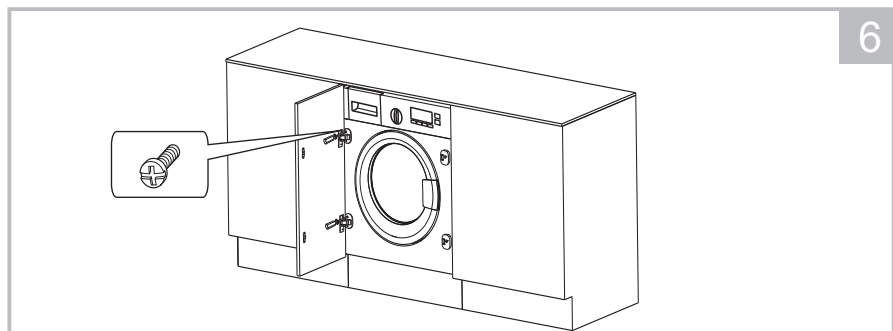

Installation the door

Warning!

- When installing the appliance into the kitchen ensure furniture ,if possible, the hoses are placed in either of the two recesses on the back of the appliance. This will help to prevent the hoses from becoming kinked or trapped.



CREATE A BETTER LIVING

洗衣乾衣機

用戶手冊

MODEL:
WD1460FMW

請閱讀本手冊
請仔細閱讀並遵循指示，
並妥善保管使用說明書，以備日後使用。

目錄

安全守則

■安全守則	2
-------	---

安裝

■產品介紹	6
■安裝步驟	7

操作

■快速操作	10
■每次洗滌之前	11
■洗滌劑分配器	12
■控制面板	14
■選項	15
■其他程序	16
■程序	18
■洗滌程序表	19

維修保養

■清潔和保養	22
■疑難排解	25
■技術規格	27

嵌入式安裝指引	30
---------	----

安全守則

■ 安全預防措施

為了您的安全，請您務必遵守本說明書中所提供的訊息，以盡量減少火災、爆炸、電擊、財產損失、人身傷害或生命損失的風險。

符號說明：



警告

符號和警告詞的組合表示潛在的危險情況。除非避免，否則可能導致死亡或嚴重傷害。



小心

符號和警告詞的組合表示可能導致輕微或微弱傷害以及財產或環境損害的潛在危險



注意

符號和警告詞的組合表示可能導致輕微或微弱傷害的潛在危險。



警告

觸電危險

- 如果電源線損壞，則必須由製造商，其維修代理商或類似合格人員進行更換，以避免發生危險。
- 請使用隨洗衣機所附送的新軟管套件，舊軟管套件不得重複使用。
- 對洗衣機進行任何維護工作之前，請拔下電源插頭。
- 使用洗衣機後請務必拔下設備電源並關閉供水。最大進水壓力以帕斯卡(Pa)為基礎單位；最小進水壓力亦以帕斯卡(Pa)為基礎單位。
- 為確保您的安全，請務必將電源插頭插入接地的插座。仔細檢查並確保您的插座正確穩固地接地。
- 請確保水和電氣設備必須由合格的技術人員根據製造商的說明和當地的安全規定進行連接。
- 清潔或維護之前，請從電源插座中拔出插頭。
- 請勿使用額定電流小於設備額定電流的任何插座。切勿用濕手拔出電源插頭。
- 請記住洗完衣服後立即斷開水和電源。

請注意兒童安全

- 如果已經在安全的情況下接受了有關洗衣機使用的監督或指導並且了解所涉及的危險，那麼 8 歲及以上的兒童、身心障礙人士(身體、感官或精神能力衰退的人士)或缺乏相關經驗和知識的人士皆可以使用洗衣機。兒童不得玩弄洗衣機。未經監督的情況下，兒童亦不得對洗衣機進行清潔和維護。
- 低於 3 歲的兒童應受到監督，以確保他們不會隨意玩弄洗衣機。
- 由於動物和兒童可能爬入洗衣機，在每次操作前請檢查洗衣機。
- 兒童應受到監督，以確保他們不會隨意玩弄洗衣機。
- 在操作過程中，本產品的玻璃門可能會變得非常熱。在非常潮濕的房間以及具有爆炸性或腐蝕性氣體的房間內操作本產品時，請讓孩子和寵物遠離機器。
- 使用本產品之前，請取下所有包裝和運輸螺栓，否則可能導致嚴重損壞。

爆炸危險

- 請不要清洗或已經用易燃物質或易爆物質(如蠟、油、油漆、汽油、脫脂劑、乾洗溶劑、煤油等)清洗，浸泡或浸漬過的物件。
- 如果使用工業化學品進行清潔，則不得使用洗衣乾衣機。
- 排出的空氣不得排入煙道，該煙道用於排出燃燒燃氣或其他燃料的設備產生的煙霧。
- 事先用手徹底沖洗洗滌物品。



注意!

洗衣機安裝說明

- 本產品僅供室內使用。
- 本產品開口不得被地毯阻擋。
- 本產品不得安裝在浴室或非常潮濕的房間以及有爆炸性或腐蝕性氣體的房間內。
- 單入口閥門的洗衣機只能連接到冷水供應源。雙入口閥門的洗衣機應正確連接到熱水供應源和冷水供應源。
- 插頭必須在確認安裝完畢之後先可以使用。
- 本產品不得安裝在可上鎖的門，滑動門或帶有鉸鏈的門後面，鉸鏈位於洗衣機的另一側。
- 本產品不得安裝在潮濕的地方。
- 本產品在使用之前，請卸下所有包裝和運輸螺栓。否則可能會造成嚴重損壞。

產品損壞可能產生的風險

- 本產品僅供家庭使用，清洗適合洗衣機清洗的紡織品。
- 不要爬上去坐在洗衣機的頂蓋上。
- 不要靠在洗衣機門上。
- 運輸洗衣機的注意事項：
 1. 運輸螺栓應由專業人員重新安裝到洗衣機上。
 2. 應排出洗衣機中的積水。
 3. 小心處理洗衣機，提起時切勿抓住洗衣機的任何突出部分，在運輸過程中機門不能當作手柄使用。
 4. 洗衣機很重，請小心運輸。
 5. 不得將手插入流水抽取桶中。
- 請不要用大力關上洗衣機門。 如果發現難以洗衣機門關閉，請檢查衣服是否均勻地放入或分配。
- 禁止使用洗衣機清洗地毯。

洗衣機操作說明

- **在第一次洗滌衣物前，洗衣機應在不放入任何衣物的情形下，進行一輪完整的空轉。**
- 禁止使用易燃、易爆或有毒溶劑。 汽油和酒精等不得用作清潔劑，請僅選擇適合機洗的洗滌劑，尤其是適合洗衣機滾筒的洗滌劑。
- 請確保所有衣物的口袋都被清空。硬幣，胸針，釘子，螺絲或石頭等尖銳硬物可能會對洗衣機造成嚴重損壞。
- 打開洗衣機門前請檢查滾筒內的水是否已排乾。如果有任何可見的水殘留，請不要打開洗衣機門。
- 洗衣機排出熱水時要特別小心以避免燙傷。
- 在洗滌過程中切勿徒手補充水分。
- 程序完成後，請等待兩分鐘再打開洗衣機門。
- 如果不可避免地含有植物油或食用油或已被頭髮護理產品污染的織物，首先應在含有額外洗滌劑的熱水中清洗，然後才放在滾筒式機中，這樣可以減少但不能消除危險。
- 必須提供足夠的通風，以避免燃燒其他燃料（包括明火）的器具回流到房間內。
- 請勿將未清洗過的物品晾乾。
- 使用食用油，丙酮，酒精，汽油，煤油，去污劑，松節油，蠟和除蠟劑等污染物品

時，應先用額外的清潔劑將其洗淨，然後再在器具中乾燥。

- 泡沫橡膠（乳膠泡沫），浴帽，防水紡織品，橡膠襯墊物品以及裝有泡沫橡膠墊的衣服或枕頭等物品不應在機器中。
- 織物柔軟劑或類似產品應按織物柔軟劑說明書的規定使用。
- 在取水期間可以打開機器的蓋子，但需要 15 秒或更長時間才能完全停止儲水倉的補水閥。
- 洗衣機循環的最後部分在沒有加熱（冷卻循環）的情況下發生，以確保物品保持在確保物品不會被高溫損壞。
- 在使用本產品之前，請把打火機和火柴等所有物品從口袋中取出。
- 警告：在乾燥循環結束之前，切勿關閉洗衣機，除非所有物品都快速取出並散開，以便散熱。

環境保護



2018 年12 月31 日起，被棄置受管制電器處置管制、進出口管制及堆填區棄置禁令正式實施。任何人貯存、處理、再加工或循環再造被棄置受管制電器，均須取得廢物處置牌照；輸入及輸出被棄置受管制電器均須領有許可證。堆填區及其他指定廢物處置設施（例如廢物轉運站）則不會再接收和處置被棄置受管制電器。

安裝

■ 產品介紹

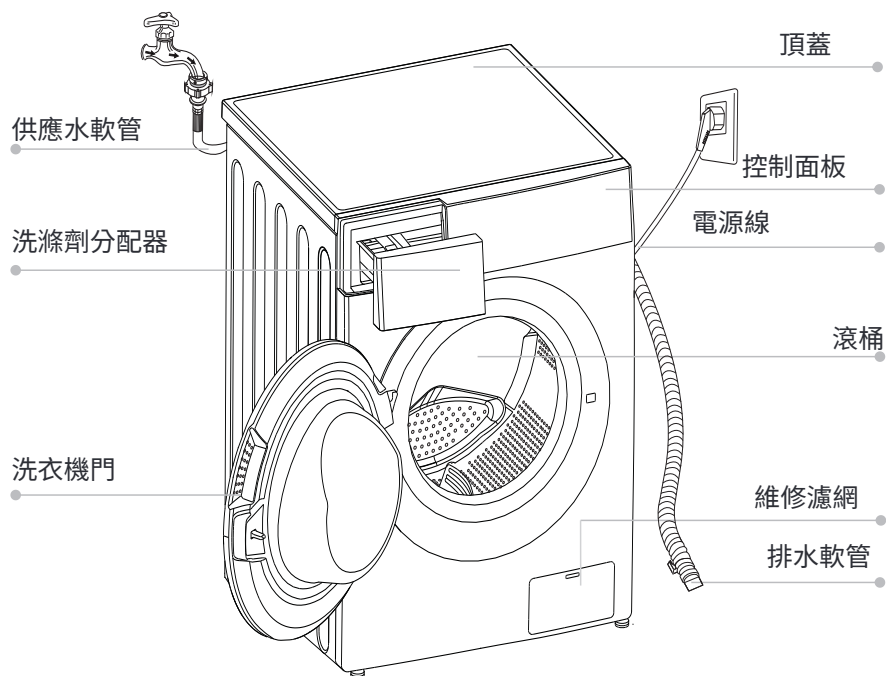

📌 注意!

產品圖片僅供參考，請以實物為準。

配件



運輸孔塞

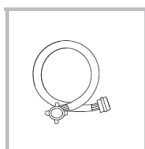

冷水供應軟管

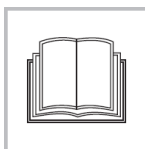

用戶說明書

■ 安裝步驟

安裝區域



警告！

- 穩定性對於防止產品滑動非常重要。
- 確保洗衣機沒有壓到電源線。

在安裝產品之前，應選擇如下特徵位置：

1. 穩固，乾燥，平整的表面。
2. 避免陽光直射。
3. 充足的通風。
4. 室溫高於 0°C。
5. 遠離諸如煤炭或天然氣等熱能資源。

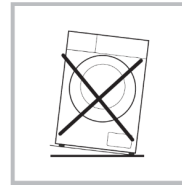
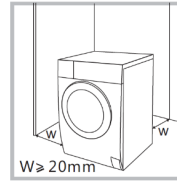

拆開洗衣機的包裝



警告！

- 包裝材料（例如薄膜，聚苯乙烯泡沫塑料）對兒童可能是危險的。
- 由於包裝有窒息的危險，所以請將包裝存放在兒童無法觸及的地方。

1. 拆開紙板箱和發泡膠包裝。
2. 提起洗衣機並移除底部包裝，請確保將小三角形泡棉與底部泡棉一起移除。

如果無法移除，請將洗衣機側面朝下平放，然後再動手將設備底部的泡棉取下。

3. 撕掉固定電源線和排水軟管的膠帶。
4. 從滾筒中取出進口軟管。

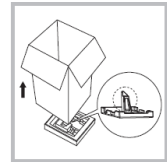

卸下運輸螺栓

⚠ 警告！

- 在使用洗衣機前，您必須從洗衣機背面移除運輸螺栓。



用扳手鬆開 4 個螺栓。

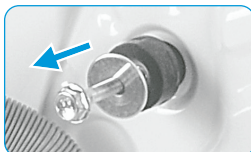

然後將螺栓和橡膠部件拆下，使用運輸孔塞堵住洞孔。並妥善保管以備未來使用。

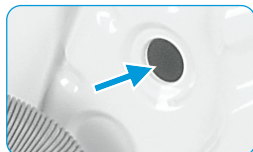

調平洗衣機

⚠ 警告！

- 所有四粒底盤的鎖緊螺母必須緊緊地連住機箱。

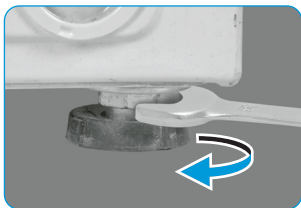

1. 鬆開鎖緊螺母。
2. 轉動機腳直至其與地板緊密接觸為止。
3. 調整機腳並用扳手鎖緊，確保洗衣機平穩。

連接供水軟管

⚠ 警告！

- 為防止洩漏或水損壞，請按照本章中的說明進行操作。
- 不要扭結，擠壓，修改或切斷供水軟管。



如圖所示，將水管的兩端連接到進水閥和冷水水龍頭。



⚠ 注意！

- 用人手連接軟管，切勿使用工具。檢查所有連接都是緊密的。

排水軟管



警告！

- 不要扭結或拉扯排水管。
- 正確放置排水軟管，否則可能會因漏水而造成損壞。

有兩種方法放置排水管末端：

1. 放入水槽。

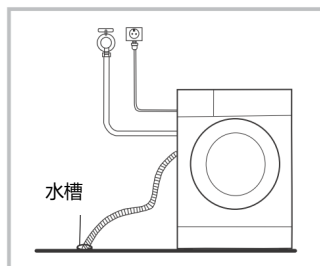

2. 將其連接到水槽的分支排水管。

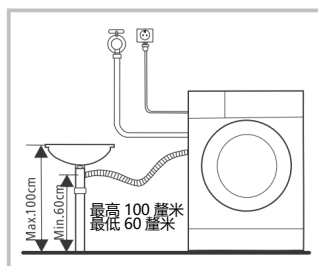

操作

■ 快速操作



注意!

- 清洗衣物之前，請確保洗衣機已經正確安裝。
- 在第一次洗滌前，洗衣機應按照以下方式在整個程序中進行無衣物的自動空轉。

🔧 校準

在第一次洗滌前，建議先校準洗衣乾衣機，以提供最佳性能。

本洗衣機能夠自動檢測裝載的衣物量。此功能能有效地減少用電量和用水量，提高產品的效能，從而節省金錢和時間。因此，建議用戶先校準洗衣機以獲得最佳使用效果。

- 1-從滾桶中取出所有衣物和物件並關上機門；
- 2-將插頭插入插座；
- 3-按電源開關鍵，然後同時按住「Speed」和「DELAY」鍵10秒，直到面板顯示「t19」；
- 4-按 [>||] 啟動設備，並等待面板顯示「****」。

1. 洗滌前

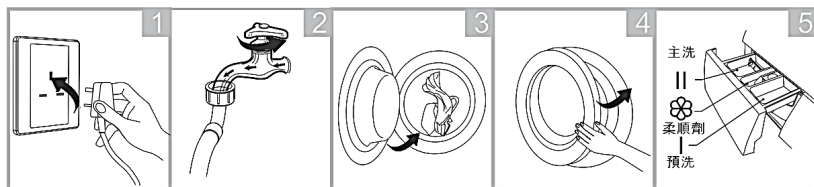

插入插頭

轉開水龍頭

倒入衣物

關閉洗衣機門

加入洗滌劑



注意!

選擇預先洗後（如果洗衣機有此功能的話），請在「洗劑分配盒 1」中添加入洗滌劑。

2. 洗滌

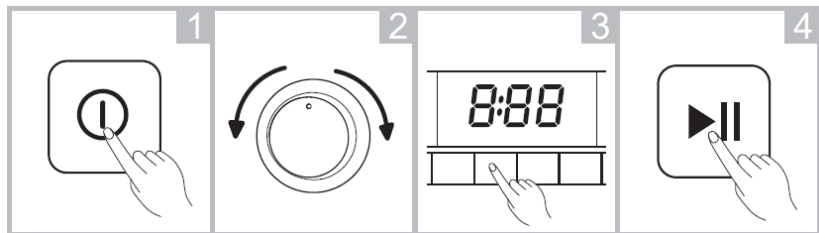

按電源開關鍵

選取合適的洗滌程序

選取功能或按默認

啟動

3. 洗滌後

面板會顯示結束字樣：“End”。

■ 每次洗滌之前

- 洗衣機的工作條件應為 5°C ~ 40°C。如果在 0°C 以下使用，進水閥和排水系統可能會遭到損害。如果洗衣機處於 0°C 或更低的溫度條件下，則應將其轉移至正常環境溫度，以確保供水軟管和排水軟管在使用前不會凍結。
- 清洗前請檢查衣物標籤和清潔劑使用說明。 使用適用於機器清洗不起泡沫或少量泡沫的洗滌劑。

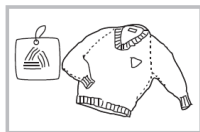

檢查衣物標籤。



從口袋裡拿出物品。

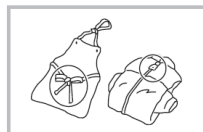

將帶子綁好、拉鍊繫上、鈕扣扣好。

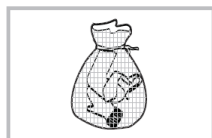

把較小的衣服放進洗衣網袋裡。

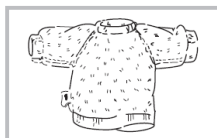

將易起毛球和長毛絨織物從裡到外翻出來。

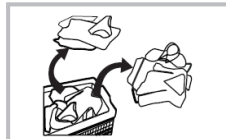

將不同材質的衣服區分開來。

⚠ 警告！

•請勿洗滌或烘乾已用蠟、油、油漆、汽油、酒精、煤油和
其他易燃材料等易燃或易爆物品清洗、洗滌、浸泡或輕拍
過的衣物。

•清洗單件衣服時，容易造成重心不穩，由於滾桶內衣物分
佈有著極大的不均衡而發出警報。因此，建議多添加一至
兩件衣服一起洗滌，令轉動更加暢順。

■ 洗滌劑分配器

- I 預洗洗滌劑槽
- II 主洗洗滌劑槽
- ☼ 衣物柔順劑槽
- ☹ 洗滌劑分配器釋放鍵

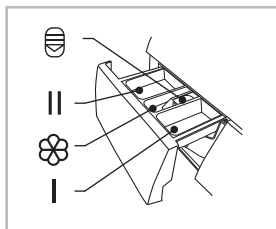

注意!

選擇預先洗後 (如果洗衣機有此功能的話), 請在「洗劑分配盒 1」中添加入洗滌劑。

程序	I	II	☼	程序	I	II	☼
棉質		●	○	乾燥			
1 小時洗衣/乾衣		●	○	脫水			
牛仔衣物		●	○	快洗		●	○
混合洗		●	○	運動衣物		●	○
羊毛		●	○	嬰兒衣物		●	○
過水及脫水			○	洗衣乾衣		●	○
節能 40-60		●	○	加強模式		●	○
20°C		●	○				

●必須

○可選

洗滌劑建議

洗滌劑建議	洗滌程序	洗滌溫度	衣物類型
含漂白劑和熒光劑的強力洗滌劑	棉質, 節能 40-60, 加強模式	40/60	由耐高溫棉或亞麻製成的白色衣物
不含漂白劑和熒光劑的彩色洗滌劑	加強模式, 棉質, 節能 40-60, 混合洗, 20°C	20/30/40	由棉或亞麻製成的彩色衣物
不含熒光劑的顏色或溫和洗滌劑	20°C	冷水/20	由纖維或合成材料製成的彩色衣物
溫和的洗滌劑	20°C	冷水/20	纖幼衣物, 如絲綢、合成纖維
羊毛專用洗滌劑	羊毛	20/30/40	羊毛

注意！

- 對於結塊或粗糙的洗滌劑或添加劑，在將其倒入洗滌劑盒之前，建議使用一些水稀釋以防止洗滌劑盒的入口在填充水時被堵塞和溢出。
- 請選擇適合不同洗滌溫度的洗滌劑類型，以獲得最佳洗滌效果，同時減少水源和能源消耗。
- 使用正確的洗滌劑劑量以達到最佳的清潔效果。
- 如果滾桶未完全裝滿，請減少洗滌劑用量。
- 根據水的硬度調整洗滌劑的用量，如果水質較軟，請使用較少洗滌劑。
- 根據衣物的髒污程度調整洗滌劑的用量，較乾淨的衣物需要較少的洗滌劑。
- 高濃縮洗滌劑更需要準確的劑量。

出現以下情況代表使用過多洗滌劑：

- 大量泡沫形成
- 洗滌和漂洗效果不佳

出現以下情況代表使用過少洗滌劑：

- 衣物變成灰色
- 在滾筒·加熱部件和/或衣物上積聚水垢

■ 控制面板

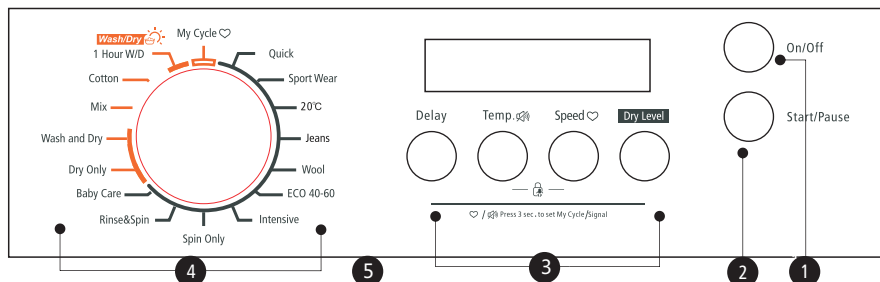

📌 注意!

圖表僅供參考，請以實物為準。

1. 電源關閉：洗衣機的電源已關閉。
2. 開始/暫停：按下按鈕開始或暫停清洗循環。
3. 選項：這允許您選擇一個附加功能，並在選中時點亮。
4. 程式：根據待洗衣物類型做選擇。
5. 屏幕顯示：此屏幕顯示洗衣機的設置，預計剩餘時間，選項和狀態消息。屏幕顯示將在整個循環中保持開啟狀態。

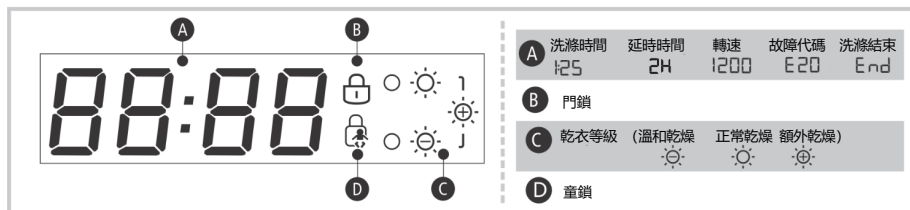

■ 選項

Delay

延時

設置延時功能：

1. 選擇一個程序；
2. 按延時鍵選擇時間（延時時間為 0-24H）；
3. 按[開始/暫停]開始延時操作。



按電源鍵

選擇程序

設定時間

按 開始

取消延遲功能：

按下[延遲]按鈕，直到屏幕顯示變成 0H 為止。在開始程序之前應該按下該按鈕。如果程序已經啟動，請關閉程序以重新設置新的程序。

❗ 注意！

如果機器在運行時電源中斷，則存儲器將存儲所選的程序，並且在重新啟動電源時，按[On / Off]按鈕，程序將繼續。

程序	選項	程序	選項
	延時		延時
棉質 (Cotton)	<input type="radio"/>	乾衣 (Dry Only)	<input type="radio"/>
1 小時洗衣/乾衣 (1 Hour W/D)	<input type="radio"/>	脫水 (Spin Only)	<input type="radio"/>
牛仔衣物 (Jeans)	<input type="radio"/>	快洗 (Quick)	<input type="radio"/>
混合洗 (Mix)	<input type="radio"/>	運動衣物 (Sport Wear)	<input type="radio"/>
羊毛 (Wool)	<input type="radio"/>	嬰兒衣物 (BabyCare)	<input type="radio"/>
過水及脫水 (Rinse & Spin)	<input type="radio"/>	洗衣乾衣 (Wash and Dry)	<input type="radio"/>
節能 Eco 40-60	<input type="radio"/>	加強模式 (Intensive)	<input type="radio"/>
20°C	<input type="radio"/>		

☐ 表示可選。

● 其他程序



我的最愛程式

記憶經常使用的程序。

按[] 3 秒機器會記住當前運行的程式。預設狀態是棉質。



兒童安全鎖

避免兒童誤觸操作



按電源鍵



按啟動鍵



按[溫度]和[速度]按鍵 3 秒鐘
直到蜂鳴器響起

⚠ 注意!

- 按兩個按鈕 3 秒，可以解除“童鎖”功能。
- “童鎖”將鎖定除[開/關] / [電源]以外的所有按鈕。
- 切斷電源，可以解除“童鎖”功能。
- 對於某些型號，當恢復供電時，童鎖將保持有效。



轉速

按下按鈕改變速度

程序	預設速度(rpm)	程序	預設速度(rpm)
	1400		1400
棉質	1400	乾衣	1400
1 小時洗衣/乾衣	1400	脫水	1000
牛仔衣物	1000	快洗	800
混合洗	800	運動衣物	800
羊毛	600	嬰兒衣物	800
過水與脫水	1000	洗衣乾衣	1400
節能 40-60	1400	加強模式	800
20°C	1000		

⚠ 注意!

- 當速度指示燈熄滅時，表示旋轉速度為 0。

Temp.

溫度

按下按鈕調節溫度（冷，20°C，30°C，40°C，60°C，90°C）



將蜂鳴器調成靜音



按電源開機 啟動程序 按下[溫度]按鍵 3 秒鐘將蜂鳴器調成靜音

要啟動蜂鳴器功能，請再次按下該按鈕 3 秒鐘。

該設置將一直保留到下一次重新設置。

⚠ 注意！

- 將蜂鳴器功能靜音後，聲音就不會再被啟動了。



乾燥水平

連續按下 Dry 按鈕選擇乾燥水平：額外乾燥/正常乾燥/溫和乾燥。



額外乾燥：需要立即穿上衣服，我們可以選擇這個功能



正常乾燥：正常乾燥程序



溫和乾燥：只需略微乾燥然後就可以了。



注意！

- 乾燥提示
 - 脫水後衣服可以乾燥
 - 為確保紡織品的干燥質量，請根據其種類和乾燥溫度對其進行分類。
 - 合成衣物應設置適當的干燥時間。
 - 如果你在曬乾後熨燙衣服，請稍等一下。
- 不適合乾燥的衣服
 - 特別精緻的物品，如合成窗簾，羊毛和絲綢，帶金屬嵌件的衣服，尼龍襪，笨重的衣服，如夾克，床罩，被子，睡袋和羽絨被不得用機器乾燥。
 - 用泡沫橡膠填充的衣服或類似於泡沫橡膠的材料不得用機器乾燥。
 - 含有固化乳液或噴髮劑，指甲溶劑或類似溶液殘留物的織物不得用機器乾燥，以避免形成有害蒸氣。

■ 程序

請按照待洗衣物類型來選擇適合程序。

程序	
棉質	洗滌由棉或亞麻製成的耐熱、耐磨紡織品。
嬰兒衣物	洗滌嬰兒衣物，可以使嬰兒衣物更清潔，並保護嬰兒肌膚。
牛仔衣物	洗滌牛仔衣物。
混合洗	洗滌由棉和合成纖維製成的混合紡織品。
運動衣物	洗滌運動衣物。
快洗	短的洗滌程序，適合作為少量洗衣的輕度洗滌。
羊毛	洗滌可手洗或可機洗的羊毛紡織品。特別溫和的洗滌程序，能防止羊毛縮水以及長時間程序暫停（紡織品停留在洗滌液中）。
脫水	具有可選轉速的額外脫水。
過水及脫水	額外的過水及脫水。
乾衣	選擇它來烘乾衣服，溫度不同。乾燥時間根據衣物量而定。
1小時洗衣/乾衣	適用於小型合成衣服或襯衫，負荷限制為 1 公斤（約 4 件襯衫）。當你有一個緊急的約會，但你的衣櫃裏卻沒有乾淨的襯衫，這個程序可以幫助你。程序只需 1 小時，包括洗滌和乾燥。備註：大毛巾或牛仔褲不適合此程序，因為它們會延長洗滌時間並影響衣物的殘留水分含量。
節能 40-60	洗滌顏色鮮豔的衣服，可以保持顏色鮮豔。 預設 40°C，不可更改，適合 40°C-60°C 的衣物洗滌 0°C。
加強模式	用以增加清洗效果，清洗時間較長。
20°C	預設 fault 20°C，可選擇冷水。
洗衣乾衣	標準能源程序。



注意！

參考您的產品以選擇程序。

■ 洗滌程序表

程序	洗衣/乾衣載重 (kg)	溫度 °C	預設時間
	8.0	預設	8.0
			1400
快洗	2.0	冷水	0:15
運動衣物	4.0	40	1:11
20°C	4.0	20	1:01
牛仔衣物	8.0	60	1:45
羊毛	2.0	40	1:07
節能 40-60	8.0	—	3:35
加強模式	8.0	40	3:48
脫水	8.0	—	0:12
過水及脫水	8.0	—	0:20
嬰兒衣物	8.0	60	1:43
※ 乾衣	16.0	—	4:14
※ 洗衣乾衣	8.0/6.0	—	5:00
※ 混合洗	8.0/6.0	40	1:20
※ 棉質	8.0/6.0	40	3:49
※ 1小時洗/乾	1.0/1.0	冷水	0:58



注意！

本表中的參數僅供用戶參考。實際參數可能與上述表中的參數不同。

含有  表示該程序可以選擇幹衣功能。

❗ 警告！

- 如果機器在運行時電源突然中斷，該進行之程序會被存儲下來，並且在電源重新啟動時，自動繼續運作。

維修保養

■ 清潔和保養



開始維護之前，請拔下插頭並關閉水龍頭。

清潔洗衣機

對洗衣機進行適當的維護可以延長其使用壽命。必要時可用稀釋的非磨損性中性洗滌劑清潔表面。如果有水溢出，請立即用濕布擦拭。尖銳的物品是不被允許的。



注意！

禁止使用甲酸及其稀釋溶劑或類似溶劑，如酒精，溶劑或化學產品等。

清潔滾筒

金屬配件殘留在滾筒內的鐵鏽應立即用無氯清潔劑清除。
切勿使用鋼絲絨。



注意！

清潔滾筒時請勿將衣物放入洗衣機。

清洗洗衣機門和玻璃

每次洗滌後，請擦拭洗衣機玻璃與洗衣機門以去除絨毛和污漬。若是絨毛堆積，可能會導致洩漏問題。

每次清洗後，請清除洗衣機門上任何硬幣、鈕扣和其他物品。

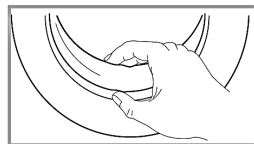

清洗進水過濾器

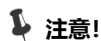

注意!

如果進水量較少，則必須清洗進水過濾器。

清洗水龍頭中的過濾器：

1. 關閉水龍頭。
2. 從水龍頭上取下供水軟管。
3. 清潔過濾器。
4. 重新連接供水軟管。

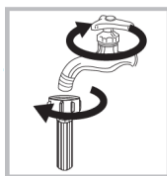

清洗洗衣機中的過濾器：

1. 轉下機器背面的進水管。
2. 用尖嘴鉗拉出過濾器，並在清洗後重新安裝。
3. 使用刷子清潔過濾器。
4. 重新連接進水管。

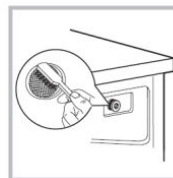

注意!

如果刷子清理不乾淨，可以拉出過濾器另外清洗；重新連接好後，再打開水龍頭。

清潔洗滌劑分配器

1. 請按下洗滌劑分配器內衣物柔順劑蓋上的箭頭。
2. 向上提起，取出柔順劑蓋，用自來水清洗所有凹槽。
3. 放回柔順劑蓋並將洗滌劑分配器置回原處

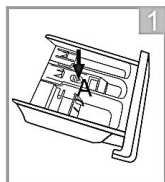

按下A處拉出分配器抽屜

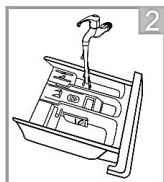

用自來水清潔洗滌劑分配器。

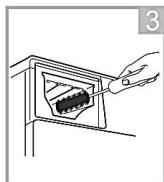

用舊牙刷清潔凹槽內部。

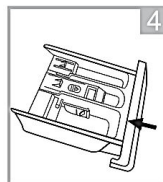

插入洗滌劑分配器。



注意!

請勿使用酒精，溶劑或化學產品清潔洗衣機。

清潔排水泵過濾器



警告！

- 小心熱水！
- 讓洗滌劑溶液冷卻下來。
- 在清洗之前拔下洗衣機插頭以避免觸電。
- 排水泵過濾器可以過濾洗滌過程中所產生的紗線和小異物。
- 定期清潔排水泵過濾器以確保洗衣機正常運行。

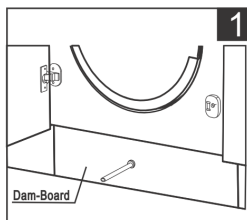

斷開電源後，拉出擋板。

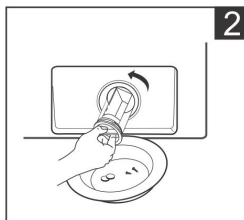

如圖所示，將過濾器調低，取出雜物。

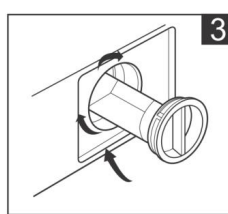

清除雜物後，請重新安裝各部分。



注意！

- 確保閘蓋和緊急排水軟管安裝正確，將蓋盤對準孔板插入，否則可能會產生漏水情形。
- 有些洗衣機沒有緊急排水軟管，因此可以跳過第 2 步和第 3 步。直接旋轉下蓋，使水流到水盆中。
- 當洗衣機根據所選的程序運轉時，幫浦中可能有熱水。在清洗過程中請勿取下泵蓋。始終等待洗衣機完成循環再取出衣物。更換蓋子時，確保它被重新牢固地轉緊。

■ 疑難排解

當洗衣機無法啟動或在運轉過程中突然停止時。首先請嘗試找到問題的解決方案，如果沒有解決方案，請聯繫服務中心。

敘述	原因	解決方案
洗衣機無法啟動	洗衣門沒有關好	請將洗衣門關好後再重新啟動，檢查洗衣門是否被衣物卡住
洗衣機門無法打開	使用者安全保護機制啟動	將電源切斷，重新啟動洗衣機
出現漏水問題	進水管或出水軟管之間未緊密連結	檢查並轉緊水管 清理出水軟管
洗劑分配盒出現殘留物	洗滌劑被弄濕或結塊	清潔並擦拭清潔劑盒
顯示屏幕無法作用	主板電源線斷開或者電線線路連接有問題	檢查電源是否被關閉和電源插頭是正確連接的
噪音		檢查固定（螺栓）是否已被移除 檢查它是否安裝在堅實而平坦的地面

故障代碼	故障原因	解決方案
E30	洗衣機門未妥善關閉	洗衣機門關閉後再重新啟動，檢查洗衣機門是否被衣服卡住
E10	射水功能出現問題	檢查水壓是否過低 將水管拉直 檢查進水閥過濾器是否堵塞
E21	排水時間過長	檢查排水管是否堵塞
E12	水溢出	重新啟動洗衣機
EXX	其他	請再試一次，如果還有問題請撥打服務熱線

注意！

檢查完成後，啟動設備。如果問題發生或顯示器再次顯示其他報警代碼，請聯繫售後服務中心。

■ 客戶服務

購買電器的 10 年內仍可配置電器的後備零件。
如有任何問題，請聯繫我們的客戶服務部：

⚠ 警告！

觸電危險

- 切勿嘗試自己修理有缺陷或可能有缺陷的設備，因為這樣做可能會對您自己和未來用戶帶來危險的可能。只有經過授權的技術人員才能進行此維修工作。
- 任何不當的維修將導致保養失效，並且令其後的損壞無法識別！

運輸

運輸洗衣機的注意事項

- 拔下電源插頭並關閉進水水龍頭。
- 檢查洗衣機門和洗滌劑分配器是否關閉。
- 從電器上拆下進水和排水軟管。
- 完全排出洗衣機中的積水。（參見「維護清潔排水泵過濾器」）
- 重要提示：重新安裝電器背面的 4 個運輸螺栓。
- 洗衣機很重，運輸時要小心。提起時切勿抓住洗衣機的任何突出部分，在運輸過程中機門不能當作手柄使用。

■ 技術規格

最大電流値:	10A
標準水壓:	0.05MPa~ 1MPa

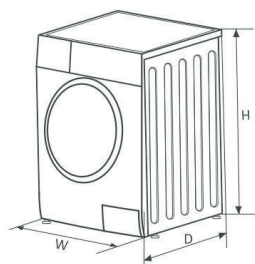

型號:	WD1460FMW
電源:	220-240V~, 50Hz
洗滌能力:	8.0kg
幹衣能力:	6.0kg
尺寸: (寬*深*高 mm)	595*540*825
淨重:	64kg
額定功率:	1900W
幹衣功率:	1300W

■ 嵌入式安裝指引

附件

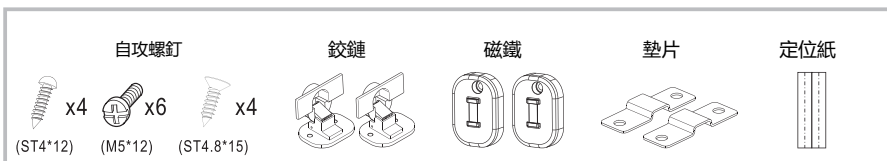

需要用到的工具

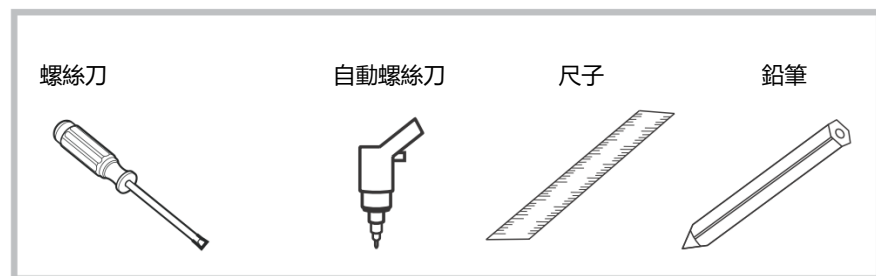

安裝步驟

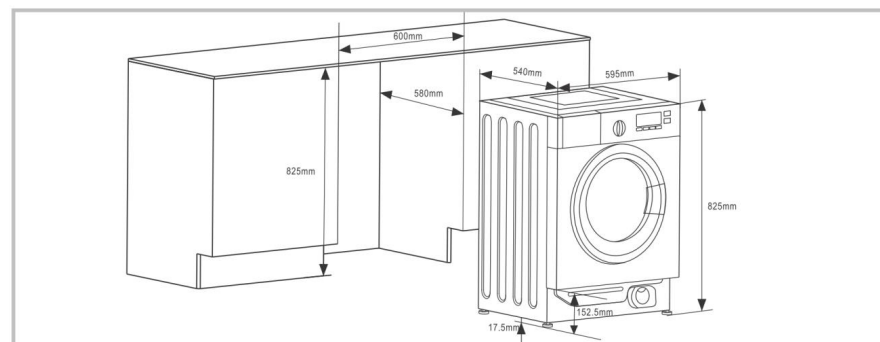

尺寸圖

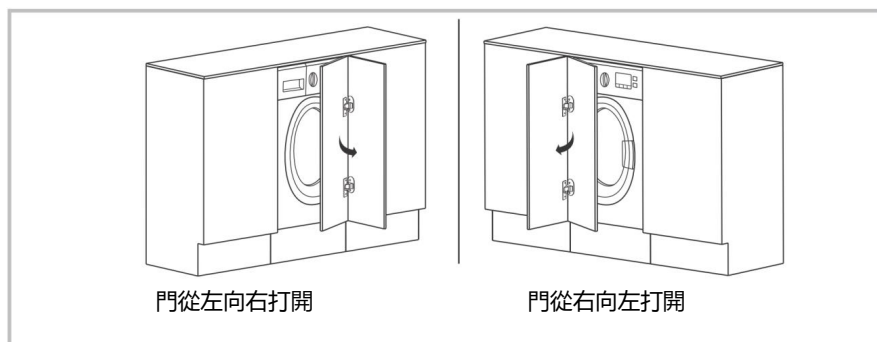

門的準備和組裝

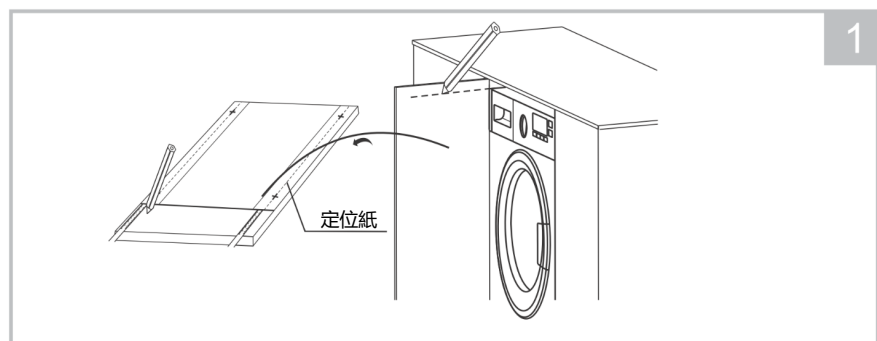

1, 在門上做標記

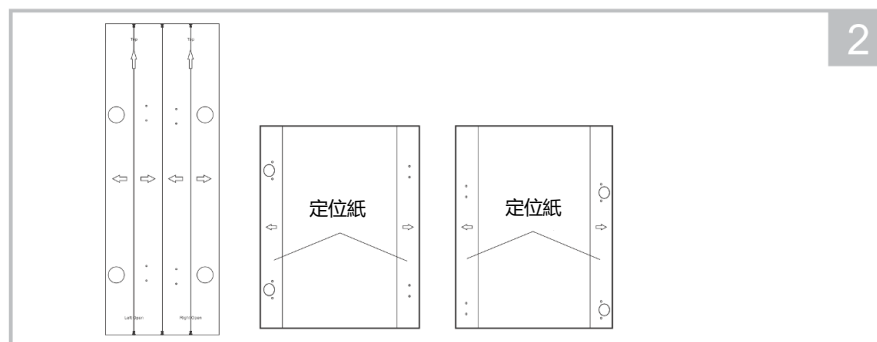

2, 在門上固定定位紙

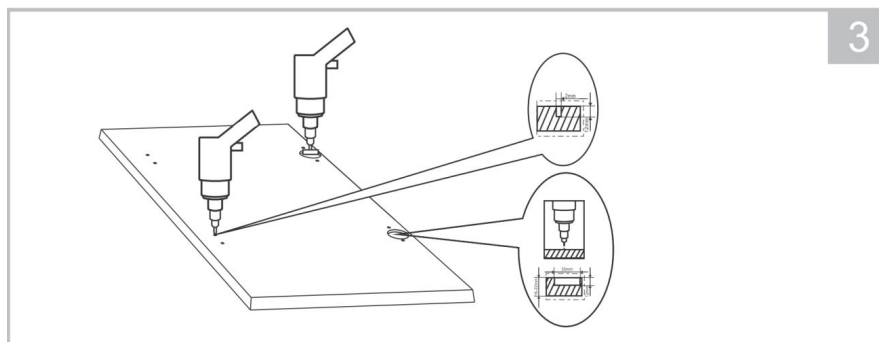

3, 在門上鑽孔

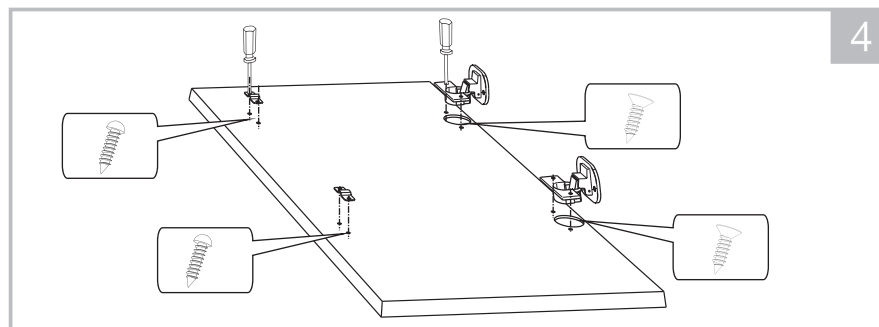

4, 安裝鉸鍊和墊片

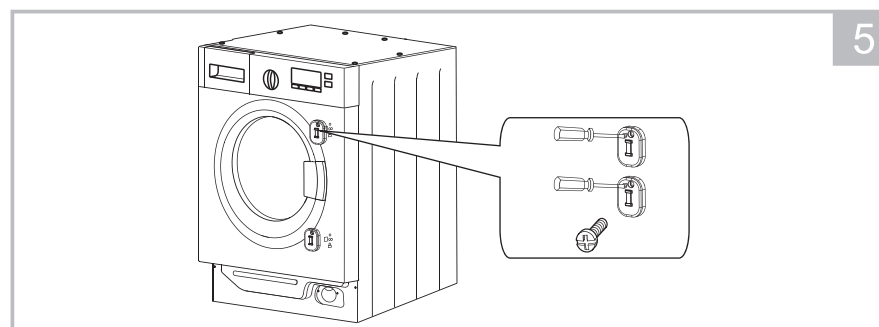

5, 安裝磁鐵

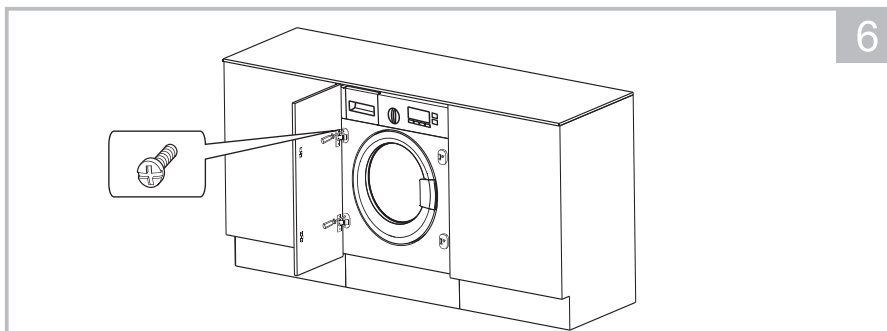

6, 安裝門



警告!

將設備安裝到廚房中時，請確保洗衣機（如果可能）放在設備背面的兩個凹槽之一中。這將有助於防止軟管扭結或卡住。